

# 1.3MPx and 3MPx Intelligent IP Dome Cameras

IP Open Standards

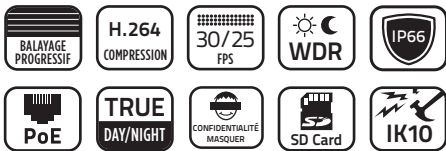

## OVERVIEW

TruVision IP Open Standards dome cameras bring state-of-the-art, high-definition pictures to the mass video surveillance market. With camera resolutions of 1.3 or 3 megapixel, these IP cameras represent a flexible video surveillance device to meet any need. Equipped with advanced technology and signal processing capability, they effectively capture video under challenging conditions.

TruVision cameras utilize H.264 compression technology with triple-streaming capability, making it easy to manage the camera's bandwidth usage. These cameras adhere to PSIA and ONVIF Profile S open communication standards, and also support a CGI command set for simple integration into any IP system. Video streams can be set for high or low bandwidth, and images can be streamed for live viewing or sent to a designated recording location.

These cameras go above and beyond standard motion detection with enhanced alarm capabilities, including cross lines, intrusion, de-focus and face detection features. Each is user-configurable to best suit the installation environment. A Region of Interest function ensures specific portions of an image are given priority during instances of high network traffic or network degradation.

Location-specific functions include a Hallway View Mode to provide a portrait view of a hallway or corridor, a De-Fog Mode to help resolve images through fog or rain and Electronic Image Stabilization for installations subject to physical vibration or shaking.



## STANDARD FEATURES

### Video

- 1.3MPx and 3MPx imagers
- H.264 compression technology with triple-streaming capability accommodates multiple settings
- Select models feature real-time video streaming up to 1080p resolution to capture every detail
- Designed to PSIA and ONVIF Profile S open standards

### Video Enhancement

- True Day/Night functionality and infrared illuminators to capture images in various lighting scenarios
- Up to 120dB of Wide Dynamic Range (WDR) performance for contrasting lighting environments
- ROI (Region of Interest), hallway view, mirror, de-fog, electronic image stabilization

### Advanced Alarm Intelligence

- Integrated motion detection and privacy masking
- Face detection, audio exception detection, cross line, intrusion detection, de-focus detection, scene change detection
- Alarm inputs and outputs provide easy notification and control of events

### Edge Recording

- Edge recording supports up to 64GB micro SD/SDXC card for audio/video playback
- Browser-supported mono and bi-directional audio to expand IP stream to include audio

## Standard Features

### Environment and Installation

- Vandal-resistant housings and polycarbonate bubbles provide an extra level of protection
- Domes feature external analog BNC video out connection for easier installation and setup
- Included TruVision Device Manager program provides fast and easy access to newly added system devices
- UL approved

## Application

Delivering detailed images in a variety of environments that need it most, TruVision® IP cameras are specifically designed for applications that require high-quality IP images. These cameras provide ideal surveillance for environments such as retail, banking, airports or gaming where detailed image capture is critical for effectively monitoring people and transactions.

## Accessories – General Bracket

### TVD-SNB

Swan Neck Bracket

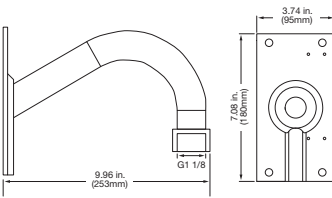

### TVD-SNB-BB

Back Box

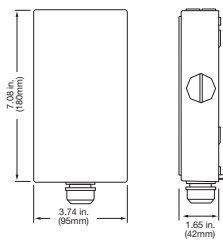

### TVD-PPB

Pendant Ceiling Bracket

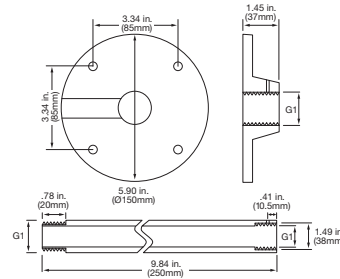

### TVD-M-PMA

Pole Mount Adaptor

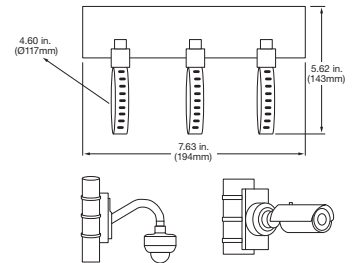

### TVD-M-CMA

Corner Mount Adaptor

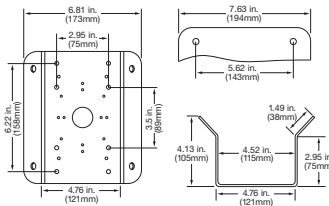

## Accessories – VF Mini Dome

### TVD-M2-WM

Indoor Dome Wall Mount

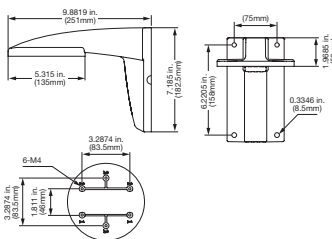

### TVD-M2-FM

Indoor Dome Flush Mount

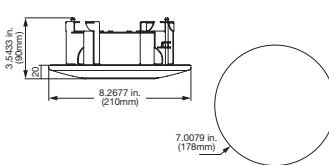

### TVD-CB3

3" Cup Base

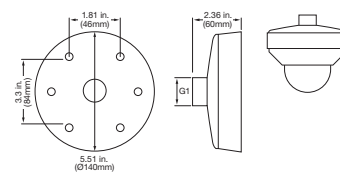



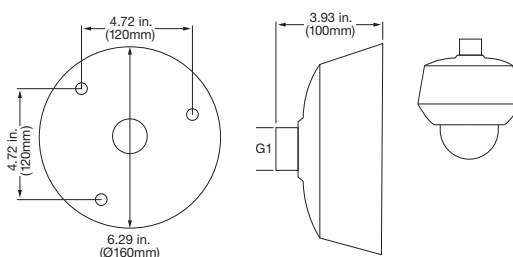

## Accessories – Motorized Lens Dome

### TVD-CB5A

Integrated 5" Cup Base



# Specifications

PART NO.		TVD-1201	TVD-1202	TVD-1203	TVD-1204	TVD-1205
Description						
Camera	Sensor	1/3" Progressive Scan CMOS				
	Day/Night	IR Cut Filter				
	IP Compression	H.264 (Baseline profile / Main profile / High profile) / MPEG4 / MJPEG				
	Maximum Resolution (@ fps)	1280 x 960 @ 25fps (50Hz) 1280 x 960 @ 30fps (60Hz)	2048 x 1536 @ 20fps (50Hz) 2048 x 1536 @ 20fps (60Hz)	1280 x 960 @ 25fps (50Hz) 1280 x 960 @ 30fps (60Hz)	2048 x 1536 @ 20fps (50Hz) 2048 x 1536 @ 20fps (60Hz)	
	Maximum Real-Time Resolution (@ fps)	1280 x 960 @ 25fps (50Hz) 1280 x 960 @ 30fps (60Hz) 1280 x 720 @ 50fps (50Hz, WDR off) 1280 x 720 @ 60fps (60Hz, WDR off)	1920 x 1080 @ 25fps (50Hz) 1920 x 1080 @ 30fps (60Hz)	1280 x 960 @ 25fps (50Hz) 1280 x 960 @ 30fps (60Hz) 1280 x 720 @ 50fps (50Hz, WDR off) 1280 x 720 @ 60fps (60Hz, WDR off)	1920 x 1080 @ 25fps (50Hz) 1920 x 1080 @ 30fps (60Hz)	
	Multiple Streaming	Triple streams				
	Video Bit Rate	128 kbps to 16 Mbps, or user-defined				
	WDR	120dB				
	Sensitivity	Color 0.01 lux @ f1.2, AGC ON B/W 0.001 lux @ f1.2, AGC ON	Color 0.1 lux @ f1.2, AGC ON B/W 0.01 lux @ f1.2, AGC ON	Color 0.01 lux @ f1.2, AGC ON B/W 0.001 lux @ f1.2, AGC ON	Color 0.1 lux @ f1.2, AGC ON B/W 0.01 lux @ f1.2, AGC ON	Color 0.1 lux @ f1.2, AGC ON B/W 0.01 lux @ f1.2, AGC ON
	S/N Ratio	50 dB (AGC OFF)				
	Auto Exposure (shutter)	50 Hz: 1s ~1/100,000s 60 Hz: 1s ~1/100,000s				
	Composite Output (BNC)	1Vp-p composite output (75 Ω/BNC)		Internal BNC port for installation only		
	Lens	2.8 ~12mm VF lens		2.8 ~12mm motorized lens		8 ~ 32mm motorized lens
	Focus	Manual		one touch Remote Auto Focus		
IR Distance	98 ft. (30m)				164 ft. (50m)	
Electrical	Voltage Input	12VDC PoE (IEEE 802.3-af)		24VAC, PoE (IEEE 802.3-af)		
	Power Consumption	Max. 8W	Max. 8.5W	Max. 12.5W (heater on)		
	I/O Connection	1/1		2/2		
	Others	RS-485				
Network	Network Protocols	TCP/IP, UDP, HTTP, DHCP, DNS, DDNS, ezDDNS, DynDNS, RTP, RTSP, PPPoE, SMTP, NTP, SNMP, HTTPS, FTP, UPnP, NAT, MULTICAST, 802.1x, Qos, IPv4, IPv6				
	PoE	IEEE 802.3-af				
	Port	10/100Mbps, auto-negotiate, Ethernet port (RJ45)				
Local Storage	Media	Micro SD/SDXC				
	Capacity	Up to 64GB				
Audio	Input	1 ch. 3.5mm audio interface (2.0 - 2.4 Vp-p, 1K ohm)				
	Output	1 ch. 3.5mm audio interface (Line level, 600 Ohm)				
	Audio Bit Rate	16Kbps				
Camera Alarms	Basic	Motion Detection, Tamper Proof, Privacy Mask				
	Advanced	Face Detection, Audio Exception Detection, Cross Line, Intrusion Detection, De-focus Detection, Scene Change Detection				
Standard & Integration		ONVIF Profile S, PSIA, CGI				
Display	Display mode	ROI (Region of Interest), Hallway View, Mirror, De-fog, Electronic Image Stabilization				
	OSD	Text overlay and picture overlay				
Mechanical/Environment	Dimensions	5.51 x 3.94 in. (140 x 100 mm)		6.29 x 5.75 in. (159.8 x 146 mm)		
	Weight	1.76 lbs. (800g)		4.63 lbs. (2100g)		
	Storage Temperature	-4°F~-158°F (-20°C~70°C)		-4°F~-158°F (-20°C~70°C)		
	Operating Temperature (cold start)	-22°F~-140°F (-30°C~60°C)		-40°F~-140°F (-40°C~60°C), with heater on		
	Operating Temperature	-22°F~-140°F (-30°C~60°C)		-58°F~-140°F (-50°C~60°C), with heater on		
	Environmental Rating	IP66				
Vandal Rating	IK10					
Regulation	Compliance	FCC, CE, UL, C-Tick, REACH, RoHS, WEEE				

# 1.3MPx and 3MPx Intelligent IP Dome Cameras

IP Open Standards

Interlogix  
National Sales Enquiries  
1300 361 479

Ground Floor  
10 Ferntree Place  
Notting Hill, Victoria 3168  
T: +61 3 239 1200  
W: [www.interlogix.com.au](http://www.interlogix.com.au)

## Dimensional Diagrams

Vandal Dome

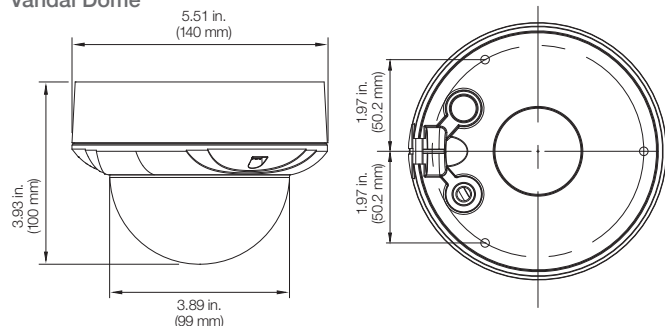

Motorized Vandal Dome

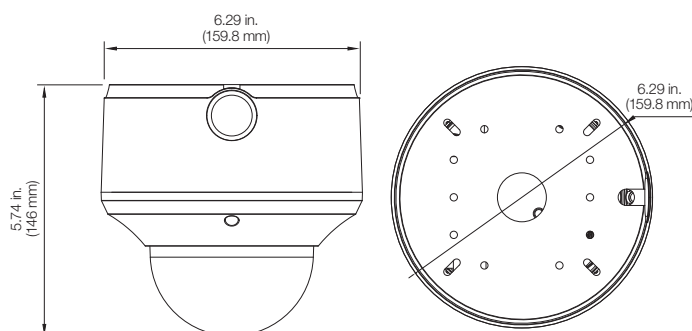

## Ordering Information

<b>TVD-1201</b>	TruVision IP Vandal Dome Camera, 1.3MPx, 2.8~12mm VF Lens, WDR, True D/N, 30m IR, Audio, Alarm, SD/SHDC Slot, Intelligence, PoE (802.3-af) / 12VDC, IP66, IK10, PAL
<b>TVD-1202</b>	TruVision IP Vandal Dome Camera, 3MPx, 2.8~12mm VF Lens, WDR, True D/N, 30m IR, Audio, Alarm, SD/SHDC Slot, Intelligence, PoE (802.3-af) / 12VDC, IP66, IK10, PAL
<b>TVD-1203</b>	TruVision IP Motorized Lens Dome Camera, 1.3MPx, 2.8~12mm Motorized Lens, WDR, True D/N, 30m IR, Audio, Alarm, SD/SHDC Slot, Intelligence, PoE (802.3-af) / 24VAC, Heater, IP66, IK10, PAL
<b>TVD-1204</b>	TruVision IP Motorized Lens Dome Camera, 3MPx, 2.8~12mm Motorized Lens, WDR, True D/N, 30m IR, Audio, Alarm, SD/SHDC Slot, Intelligence, PoE (802.3-af) / 24VAC, Heater, IP66, IK10, PAL
<b>TVD-1205</b>	TruVision IP Motorized Lens Dome Camera, 3MPx, 8~32mm Motorized Lens, WDR, True D/N, 50m IR, Audio, Alarm, SD/SHDC Slot, Intelligence, PoE (802.3-af) / 24VAC, Heater, IP66, IK10, PAL

Specifications subject to change without notice.

Copyright © 2015 UTC Fire & Security Australia Pty Ltd.  
All rights reserved.

UTC Fire & Security Australia Pty Ltd trading as Interlogix is a UTC Climate, Controls & Security company.



TRU\_IPDOME-DS-151027-1